

# 2023 Hilltopper 5K, Los Alamos, NM

measured by Tim Newell  
[tnewell@iCloud.com](mailto:tnewell@iCloud.com)  
 August 10, 2023

This course was measured using the full width of the road and the Shortest Possible Route (SPR). There are no restrictions.

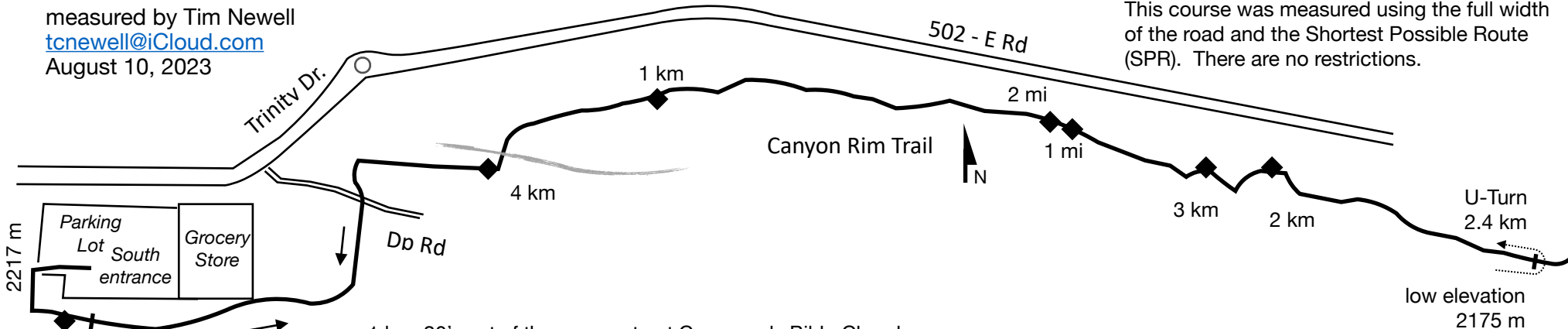

- 1 km. 30' east of the open gate at Crossroads Bible Church.
- 2 km. 60' east of post marker '1'
- 3 km. 177' east of the 0.75 mile marker post.
- 4 km. At the 'turn north' sign on the south side of the bridge.

- 1 mile: 35.880580N, 106.280546W. Dead tree on south side of trail
- 2 miles 35.880721N, 106.280798W. Rock on tree stump on south side of trail
- mile 1 and 2 are separated by 81'*
- 3 miles. 37' west of electrical box, 81' west of the starting line.

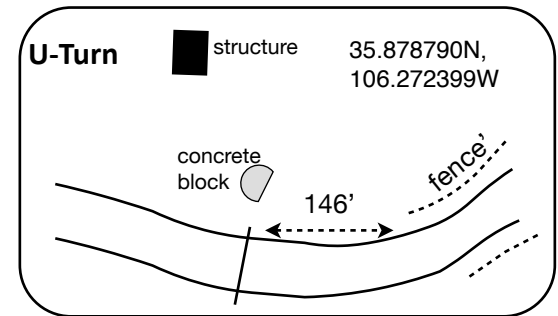

Start on the Canyon Rim trail south side of the grocery store parking lot. Follow trail east across DP road and to the U-turn. Return past the start, follow the paved trail as it turns right (north) and ends at the south entrance to parking lot. Turn west to the finish.

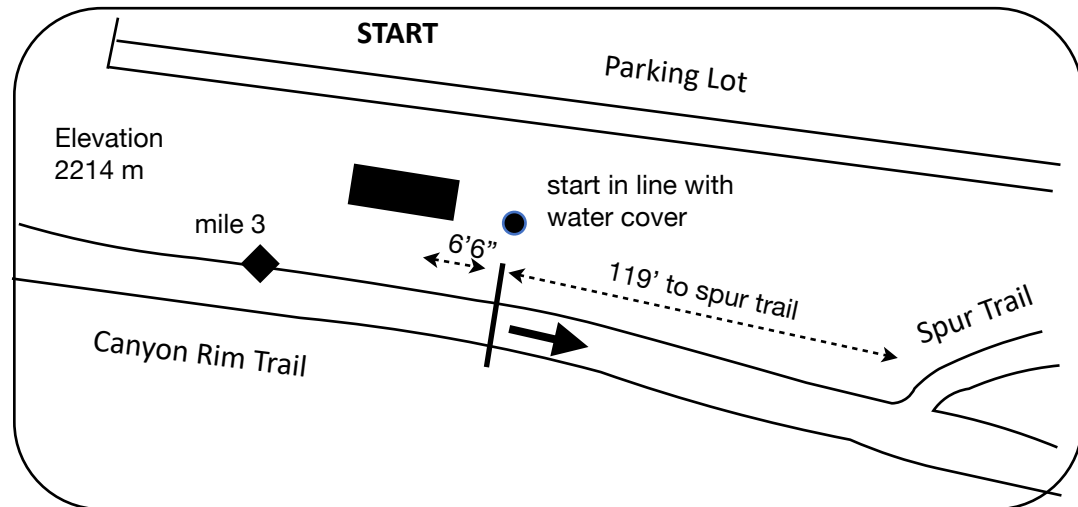
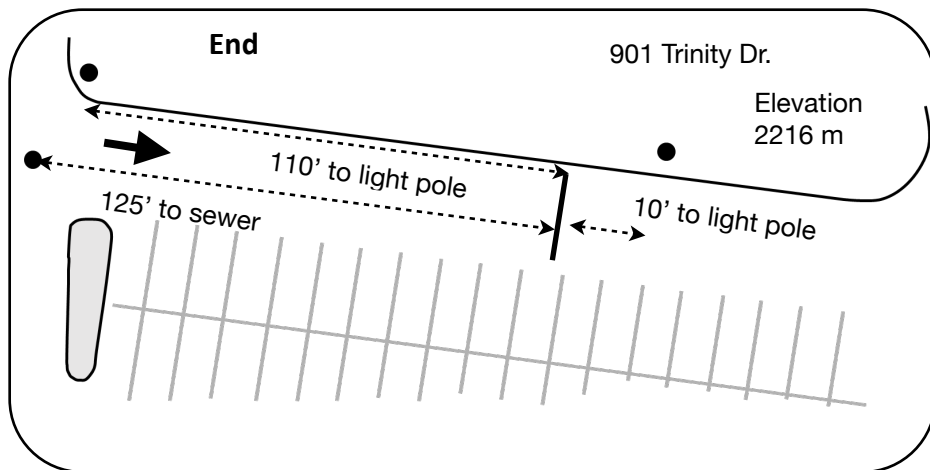

## 2023 Hilltopper 5K Markers

Tim Newell

### Start

Canyon Rim trail. In line with a water cover to the north. 6'6" east of an electrical housing unit. 119' to the spur trail leading up to the parking lot.

### Finish

Parking lot at a large decorative rock in the median, 10' west of one light pole and 110' east of another light pole. 125' west of a sewer cover.

### U-Turn

35.878790N, 106.272399W. A concrete block enclosing rebar is on the north side of the trail. To the north is a rectangular metal utility shed. 146' west of split rail fence on curve.

### Marks

1 km. 30 feet east of the open gate leading to the Crossroads Bible Church parking lot.

2 km. 60' east of post marker '1'

3 km. 177' east of the 0.75 mile marker post. Just west of a re-paved section of asphalt across the trail.

4 km. At the 'turn north' sign on the south side of the bridge across the canyon.

1 mile: 35.880580N, 106.280546W. Dead tree on south side of trail

2 miles 35.880721N, 106.280798W. Rock on tree stump on south side of trail

*mile 1 and 2 are separated by 81'*

3 miles. 37' west of electrical box, 81' west of the starting line.

### Kids 1 mile fun run

Start and End as above.

1 mile U-Turn. Go east (north) of the DP street crossing and turn east. Th U-turn is 11 feet past the end of the metal rail fence on the north side of trail.



Start and Mile 3



1 km location



5K U-Turn. Split rail fence is east of the U-Turn.

# Hilltopper 5 mile, Los Alamos, NM

measured by Tim Newell

[tcnewell@iCloud.com](mailto:tcnewell@iCloud.com)

July 5, 2024

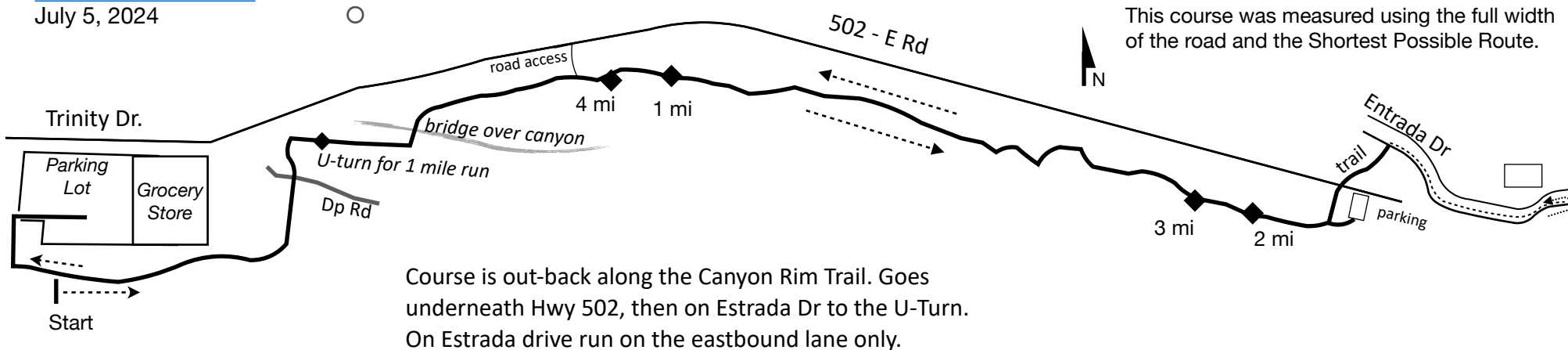

Mile 1: 35.880580N, 106.280546W. Dead tree on south side of trail. About 200m east of mile 4.

Mile 2: 35.877299N, 106.264100W. Split rail fencing on both sides of trail with drain culvert underneath.

Mile 3: 35.878333N, 106.265643W. 16 feet west of the east end of the wooden bridge.

Mile 4: 35.880771N, 106.282650W. East of Fire station and about 200 feet east of trail spur to access ramp for E Street

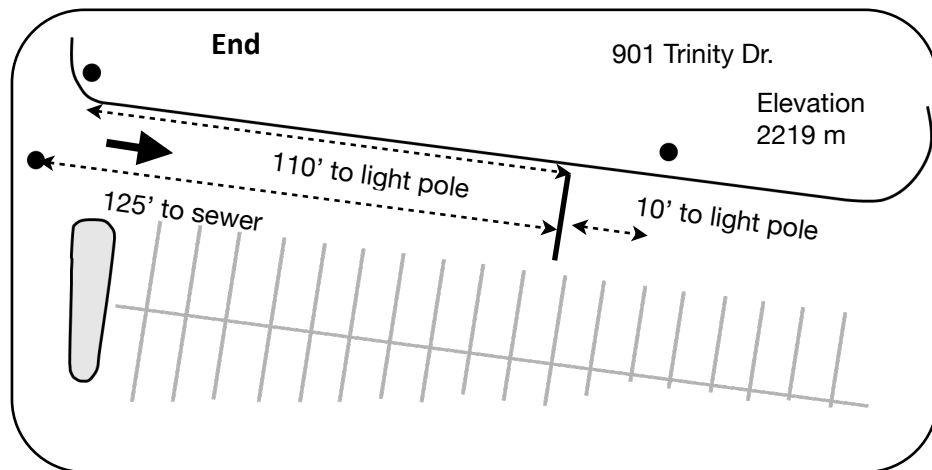
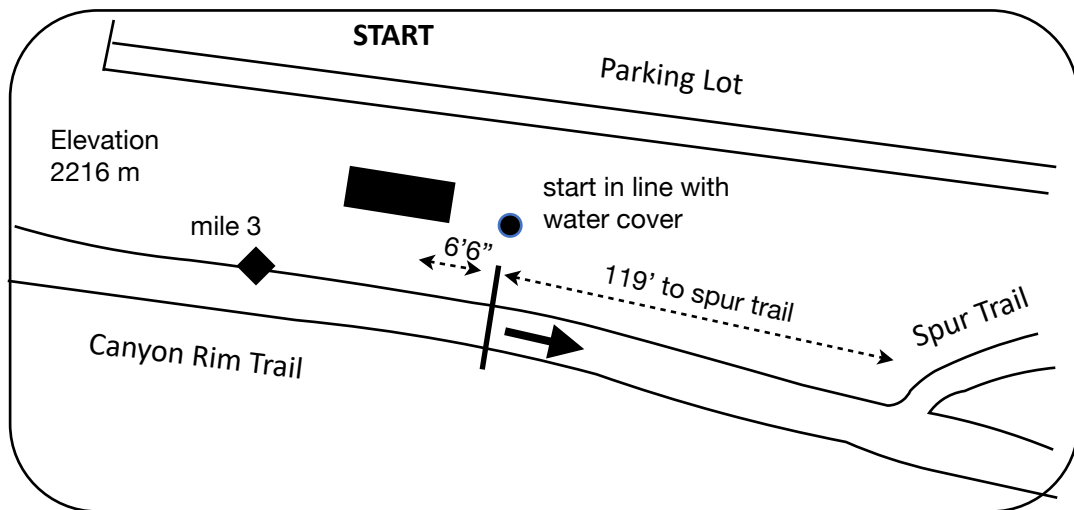
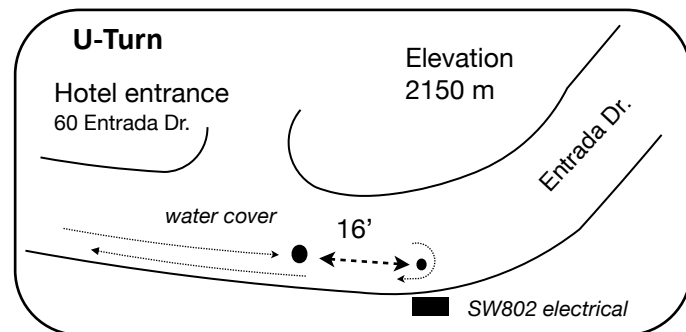

## 2024 Hilltopper 5 Mile Markers

Tim Newell

July 5, 2024

### Start

Canyon Rim trail. In line with a water cover to the north. 6'6" east of an electrical housing unit. 119' to the spur trail leading up to the parking lot. Nail on side of trail.

Elevation: 2216m (7272 ft)

### Finish (Mile 5)

Smith's Grocery Store Parking lot at a large decorative rock in the median, 10' west of one light pole and 110' east of another light pole. 125' west of a sewer cover. Nail in the top of the concrete curb.

Elevation: 2219m (7280 ft), high point.

### U-Turn

60 Entrada Drive on east side of entrance to the Holiday Inn Express hotel. 21 feet east of the water cover in the road. To the south is SW802 electrical box. Nails on south side of the road.

Elevation: 2150m (7054 ft), low point.

**Mile 1:** 35.880580N, 106.280546W. Dead tree on south side of trail. Access mile 1 from the access ramp on the east side of the Fire Station on E Street. Mile 1 is 200 m east of Mile 4.

**Mile 2:** 35.877299N, 106.264100W. Split rail fencing on both sides of trail with drain culvert underneath.

**Mile 3:** 35.878333N, 106.265643W. On the wooden bridge. 16 feet west of the east end of the wooden bridge.

**Mile 4:** 35.880771N, 106.282650W. East of Fire station. About 200 feet east of trail spur to access ramp for E Street.